

108TSST

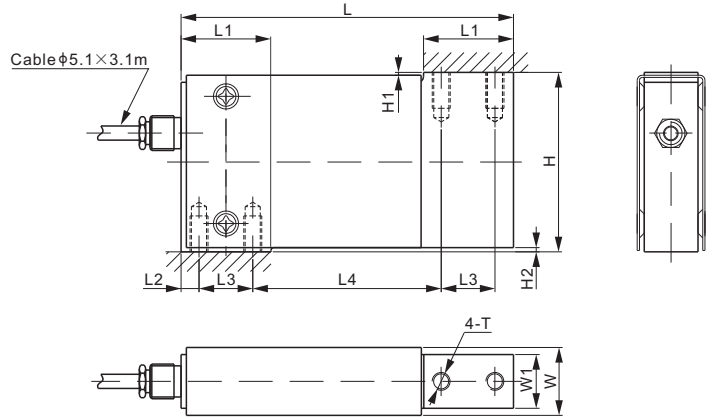

Stainless Steel



DIMENSIONS

RATED CAPACITY	H	H1	H2	L	L1	L2	L3	L4	W	W1	T
lb/inches											
10-100	2.50	0.04	0.06	4.63	1.25	0.25	0.75	2.63	0.95	0.75	1/4-28 UNF-2B Depth0.5
kg/mm (conversion of above dimensions)											
4.54-45.4	63.5	1.0	1.5	117.6	31.8	6.40	19.0	66.7	24.1	19.0	1/4-28 UNF-2B Depth12.7

SPECIFICATIONS

Full Scale Output	2.0 mV/V \pm 10%	Recommended Excitation	10V (15V Maximum)
Zero Balance	\pm 0.02 mV/V	Reference Max. Platform Size	Capacity \leq 25lb: 200x250 mm Capacity \geq 50lb: 300x300 mm
Non-linearity	$< \pm$ 0.017%	Insulation Resistance	> 2 [50V DC] G Ω
Repeatability	$< \pm$ 0.017%	Compensated Temperature Range	-10°C to 50°C / 14°F to 122°F
Hysteresis Error	$< \pm$ 0.017%	Safe Overload	150% of full scale
Creep in 30 min.	$< \pm$ 0.023%	Breaking Overload	300% of full scale
Input Resistance	385 Ω \pm 15	Seal Type / IP Rating	Environmentally Sealed / IP66
Output Resistance	350 Ω \pm 5	Cable Color Code	Exc+ Red Exc- Black Sig+ Green Sig- White Shield Bare
Element Material	2Cr13 Stainless Steel		

PART NUMBER*

Rated Capacity	Part No.	Weight (kg) Approx.
10lb.....	108TSST-10lb-YZ.....	0.9
15lb.....	108TSST-15lb-YZ.....	0.9
25lb.....	108TSST-25lb-YZ.....	0.9
50lb.....	108TSST-50lb-YZ.....	0.9
100lb.....	108TSST-100lb-YZ.....	0.9

* ATEX, FM, IECEx approved versions carry the "-Ex" suffix.

INTERCHANGEABLE REFERENCE

Manufacturer	Model
Coti Global.....	CG-51
Vishay Sensortronics.....	60051