

# 563SH

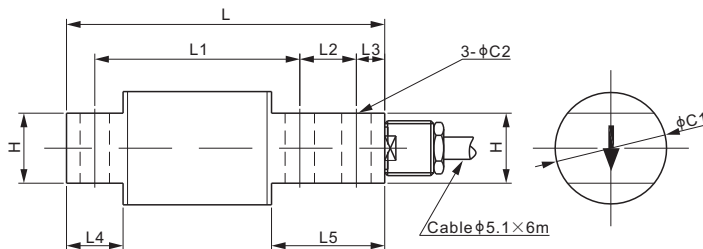

## Alloy Steel

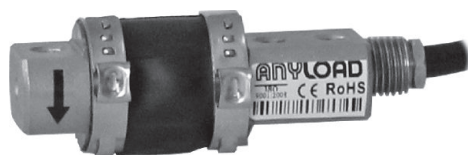

SINGLE ENDED BEAMS

CE RoHS

### DIMENSIONS

RATED CAPACITY	C1	C2	H	L	L1	L2	L3	L4	L5
<b>lb/inches</b>									
25-500	1.30	0.26	0.62	2.81	1.81	0.50	0.25	0.50	1.00
<b>kg/mm</b> (conversion of above dimensions)									
11.34-226.8	33.0	6.6	15.7	71.4	46.0	12.7	6.35	12.7	25.4

### SPECIFICATIONS

<b>Full Scale Output</b>	3.0 mV/V ± 10%	<b>Recommended Excitation</b>	10V (15V Maximum)
<b>Zero Balance</b>	± 0.02 mV/V	<b>Insulation Resistance</b>	>2 [ 50V DC ] GΩ
<b>Combine error</b>	0.03% of full scale	<b>Compensated Temperature Range</b>	-10°C to 50°C / 14°F to 122°F
<b>Non-linearity</b>	< ± 0.030%	<b>Safe Overload</b>	150% of full scale
<b>Repeatability</b>	< ± 0.020%	<b>Breaking Overload</b>	300% of full scale
<b>Hysteresis Error</b>	< ± 0.020%	<b>Seal Type / IP Rating</b>	Environmentally Sealed / IP65
<b>Creep in 30 min.</b>	< ± 0.030%	<b>Cable Color Code</b>	Exc+ Red      Exc- Black
<b>Input Resistance</b>	400Ω ± 20		Sig+ Green    Sig- White
<b>Output Resistance</b>	350Ω ± 3		Shield Bare
<b>Element Material</b>	Alloy Steel, Nickel Plated		

### PART NUMBER

Rated Capacity	Part No.	Weight (kg) Approx.
25lb.....	563SH-25lb.....	0.26
50lb.....	563SH-50lb.....	0.26
100lb.....	563SH-100lb.....	0.47
150lb.....	563SH-150lb.....	0.47
200lb.....	563SH-200lb.....	0.47
250lb.....	563SH-250lb.....	0.47
500lb.....	563SH-500lb.....	0.47

### INTERCHANGEABLE REFERENCE

Manufacturer	Model
Artech.....	50210
Rice Lake.....	RL50210
Vishay Revere Transducers.....	5503
Vishay Sensortronics.....	60040