

## Alloy Steel; Wireless Tension Link; Patent Design

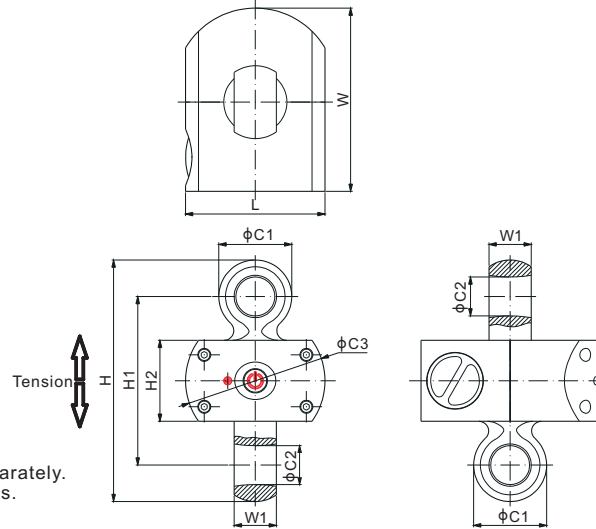

**TENSLINK™**



\* Indicator to be ordered separately. Refer to Page 185 for details.

CE RoHS

TENSION LINKS

RATED CAPACITY	DIMENSIONS									SUGGESTED SHACKLE	
	C1	C2	C3	H	H1	H2	L	W	W1		
<b>t/mm</b>											
0.5; 1; 2	33.0	18.0	80.0	110.0	74.0	38.0	80.0	110.0	18.0	Crosby G-2130-2t or SBX-2t	
3	35.0	21.0	80.0	129.0	88.0	38.0	80.0	110.0	25.0	Crosby G-2130-3.25t or SBX-3.25t	
5	50.0	27.0	86.0	164.6	110.6	50.0	86.0	113.0	33.0	Crosby G-2130-6.5t or SBX-6.5t	
10	63.0	37.0	86.0	205.0	135.0	50.0	86.0	125.0	41.0	Crosby G-2130-12t or SBX-12t	
20	90.0	53.0	100.0	249.0	153.0	53.0	100.0	140.0	66.0	Crosby G-2130-25t or SBX-25t	
30	87.0	44.0	100.0	248.0	150.0	50.0	100.0	152.0	58.0	Crosby G-2140-30t or TBX-30t	
50	115.0	62.0	150.0	321.0	206.0	74.0	150.0	170.0	79.0	Crosby G-2140-55t or TBX-50t	
100	170.0	88.0	180.0	442.0	260.0	65.0	180.0	190.0	122.0	Crosby G-2140-120t or TBX-110t	
<b>Kilb/inches</b> (conversion of above dimensions)											
1; 2; 4	1.30	0.71	3.15	4.33	2.91	1.50	3.15	4.33	0.71	Crosby G-2130-2t or SBX-2t	
5	1.38	0.83	3.15	5.08	3.46	1.50	3.15	4.33	0.98	Crosby G-2130-3.25t or SBX-3.25t	
10	1.97	1.06	3.39	6.48	4.35	1.97	3.39	4.45	1.30	Crosby G-2130-6.5t or SBX-6.5t	
20	2.48	1.46	3.39	8.07	5.31	1.97	3.39	4.92	1.61	Crosby G-2130-12t or SBX-12t	
40	3.54	2.09	3.94	9.80	6.02	2.09	3.94	5.51	2.60	Crosby G-2130-25t or SBX-25t	
60	3.43	1.73	3.94	9.76	5.91	1.97	3.94	5.98	2.28	Crosby G-2140-30t or TBX-30t	
100	4.53	2.44	5.91	13.03	8.11	2.91	5.91	6.69	3.11	Crosby G-2140-55t or TBX-50t	
200	6.69	3.46	7.09	17.40	10.24	2.56	7.09	7.48	4.80	Crosby G-2140-120t or TBX-110t	

SPECIFICATIONS				
Division	500kg	0.1kg	<b>Combined Error</b>	0.03%
	1t	0.2kg	<b>Max. Safety Load</b>	200% of full scale
	2t	0.5kg	<b>Ultimate Load</b>	500% of full scale
	3t, 5t	1kg	<b>Transmission Range</b>	Up to 30m at lowest power setting.
	10t	2kg		Up to 75m at highest power setting, unobstructed
	20t	5kg	<b>Rechargeable Battery Type</b>	3 × AA Alkaline batteries
	30t, 50t	10kg	<b>Operation Time</b>	Up to 100 hours at 20°C and at the lowest power setting
	100t	20kg	<b>Operating Humidity</b>	<85% RH under 20°C [68°F]
	<b>IP Rating</b>	IP67	<b>Operating Temperature</b>	-10°C to 50°C / 14°F to 122°F
	<b>Enclosure</b>	Alloy Steel, Powder Coating		

PART NUMBER			
Rated Capacity	Frequency	Part No.	Self Weight Approx. (kg)
500kg.....	433 MHz.....	110RH-ST-500kg-WL01.....	0.6
	915 MHz.....	110RH-ST-500kg-WL02.....	0.6
1t.....	433 MHz.....	110RH-ST-1t-WL01.....	0.6
	915 MHz.....	110RH-ST-1t-WL02.....	0.6
2t.....	433 MHz.....	110RH-ST-2t-WL01.....	0.6
	915 MHz.....	110RH-ST-2t-WL02.....	0.6
3t.....	433 MHz.....	110RH-ST-3t-WL01.....	1.0
	915 MHz.....	110RH-ST-3t-WL02.....	1.0
5t.....	433 MHz.....	110RH-ST-5t-WL01.....	1.4
	915 MHz.....	110RH-ST-5t-WL02.....	1.4

PART NUMBER			
Rated Capacity	Frequency	Part No.	Self Weight Approx. (kg)
10t.....	433 MHz.....	110RH-ST-10t-WL01.....	2.3
	915 MHz.....	110RH-ST-10t-WL02.....	2.3
20t.....	433 MHz.....	110RH-ST-20t-WL01.....	4.7
	915 MHz.....	110RH-ST-20t-WL02.....	4.7
30t.....	433 MHz.....	110RH-30t-WL01.....	5.5
	915 MHz.....	110RH-30t-WL02.....	5.5
50t.....	433 MHz.....	110RH-50t-WL01.....	16.0
	915 MHz.....	110RH-50t-WL02.....	16.0
100t.....	433 MHz.....	110RH-100t-WL01.....	35.0
	915 MHz.....	110RH-100t-WL02.....	35.0